

# VANITY TOP INSTALLATION

The following detailed instructions should be read completely before starting the work, and followed in sequence.

## **Step 1. TRIAL FIT**

Make sure that the vanity is level and firmly secured to the wall. Trial fit the vanity top onto the vanity to ensure the size is correct and the top is level. If the vanity top needs to be sized or scribed into the wall, use a belt or block sander with course grit (60 or 80 grit) to trim and size the ends.

**EXPOSED AND FINISHED ENDS CANNOT BE SANDED WITHOUT RUINING THE FINISH**

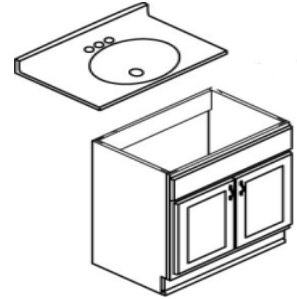

## **Step 2. INSTALL THE FAUCET**

Remove the vanity top and install the faucet and supply lines. When installing the drain assembly use only 100% silicone to seal the drain.

### **DO NOT USE PLUMBER'S PUTTY**

(Use of plumber's putty will void the warranty). Be sure to follow the faucet manufacturer's instructions when tightening the nut on the underside of the bowl.

### **DO NOT OVER-TIGHTEN**

The nut should only be hand-tightened in order to reduce the potential for the bowl to crack over time.

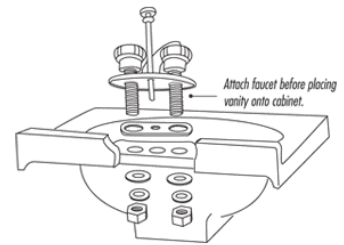

## **Step 3. INSTALL THE VANITY TOP**

Place a small bead of silicone caulking on the top edge on the cabinet. Be sure not to use an excessive amount. A little goes a long way. Carefully place the vanity top on the cabinet in the same place where it was trial fitted and firmly press it into position. Wipe away any excess sealant and let set until dry.

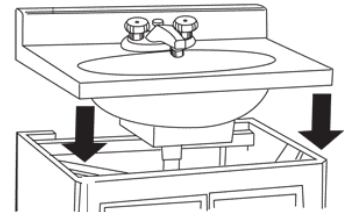

### *CARE INSTRUCTIONS:*

All North Coast Cultured Products are covered with a bacteria-resistant gel-coat surface designed for cultured marble, onyx, granite, and engineered stone. Proper care of this gel coat will yield years of excellent use. Never clean with an abrasive powder or liquid cleanser. Use of abrasives will cause scratching and will eventually dull and destroy the finish. Use of scrub brushes should be avoided for the same reason. 409 Sprays are recommended, with either washcloths or sponges. Use of a soft, dry towel after cleaning will help to remove soap spots.

To maintain luster and make cleaning easier, periodic applications of paste wax or products like gel gloss may be applied. Mild abrasives such as automotive polishing compound, toothpaste or baking soda will remove simple scratches and stains. Cigarette burns can normally be removed without noticeable effect. Additional care advice may be obtained by contacting your local North Coast Cultured Products dealer or distributor, or at [www.northcoastmarble.com](http://www.northcoastmarble.com)

**KEEP YOUR NORTH COAST CULTURED PRODUCT IN A CLIMATE-CONTROLLED SPACE AND IN THE ORIGINAL PACKAGING, LAYING FLAT UNTIL INSTALLED.**